

Client
Steven Draper

Project
**The Barn At Top O'th
Quarlton Farm,
Off Ramsbottom
Road, Hawkshaw
Bury, BL8 4JX**

Drawing
**Existing and
Proposed 2nd Floor
(Split into 4
Dwellings)**

Drawing No. **2017/208**
Scale 1:100 at A3
Date **Dec 2017**

Drawn **Harry Jackson
Surveyors**
Unit 4a Farnworth Park Ind Est,
Wellington Street, Farnworth,
Bolton,
BL4 7BY 01204 701740

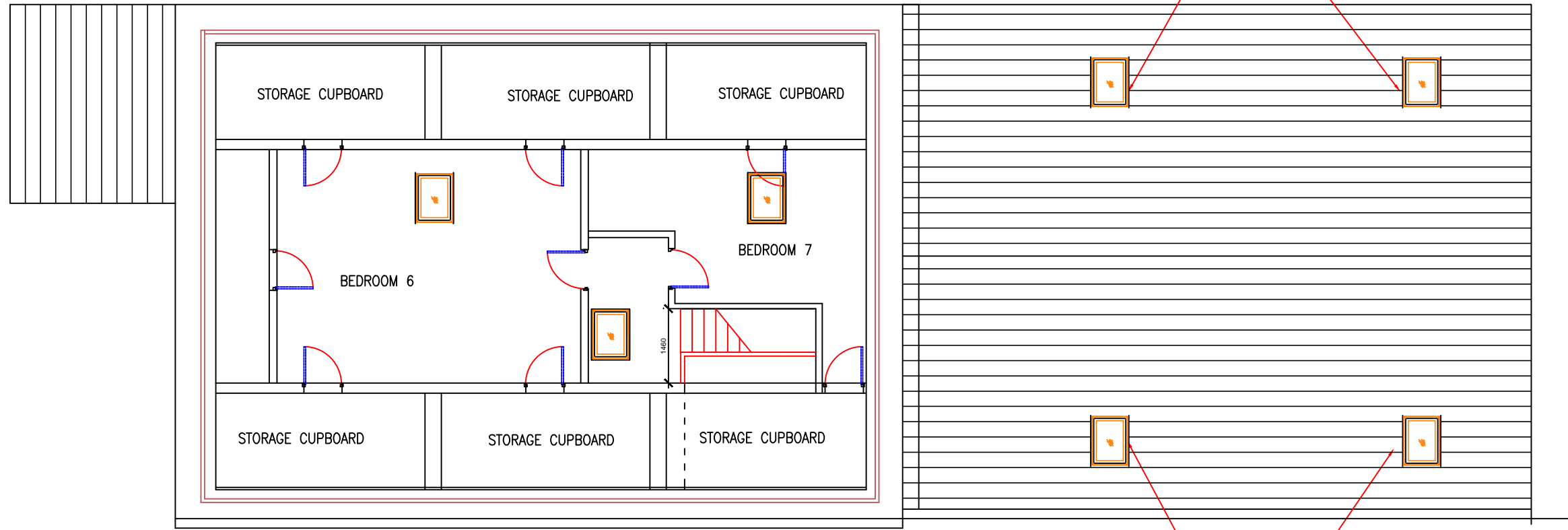

Existing Second Floor Layout

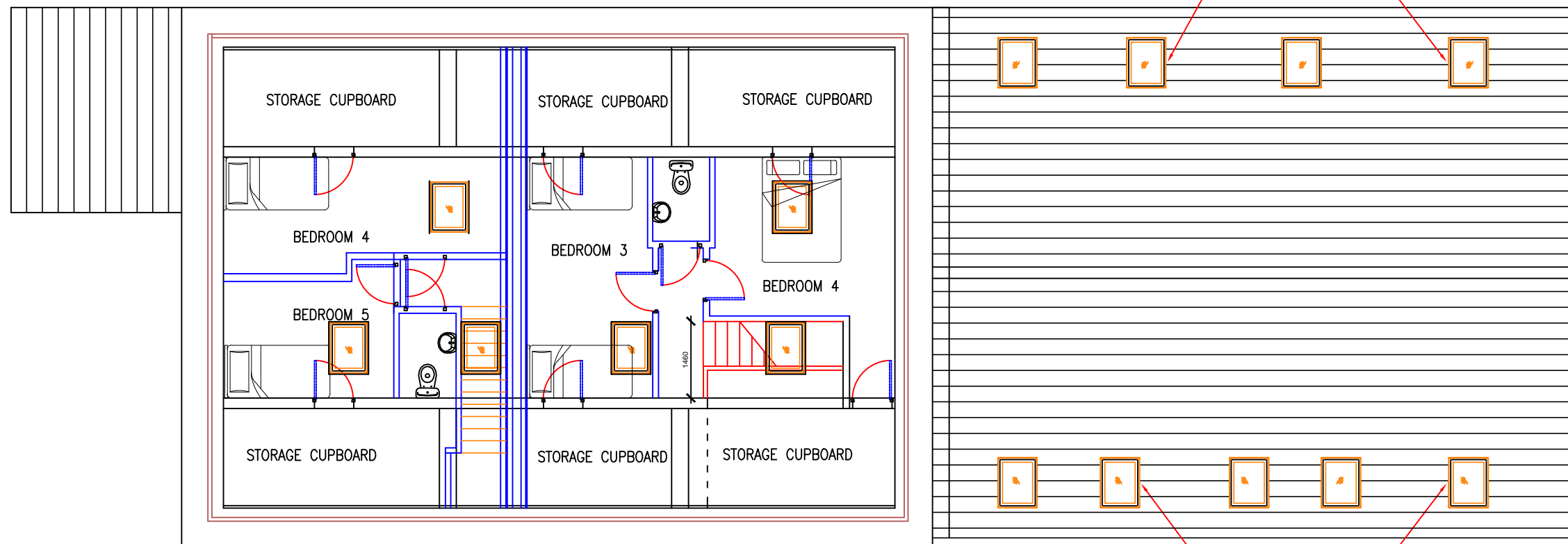

Proposed Second Floor Layout